

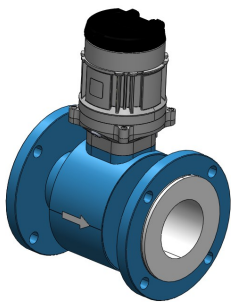

Inside the Box

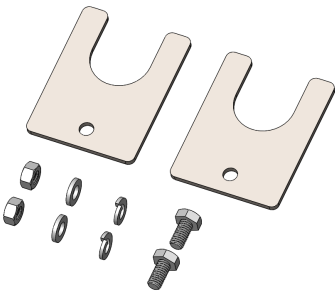

GEM2 Flow Meter w/ Battery Pack



Ground Lug Kit

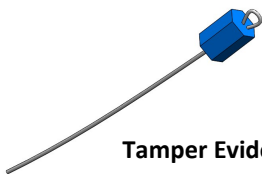

Tamper Evident Seals



Optional Power/Output Cable w/ Resistor

Meter Positioning

Choose recommended positions to ensure a full pipe

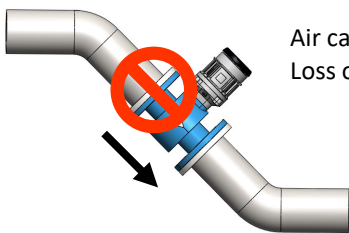

Air can be trapped.  
Loss of accuracy

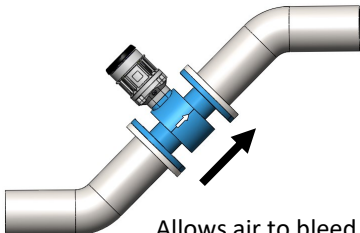

Allows air to bleed off.  
Higher accuracy

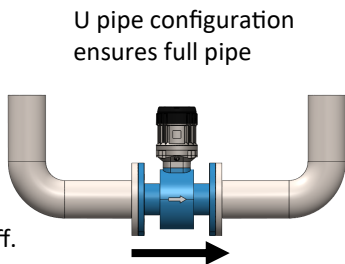

U pipe configuration  
ensures full pipe

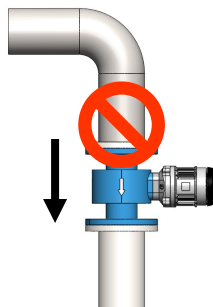

Vertical downflow  
Open discharge

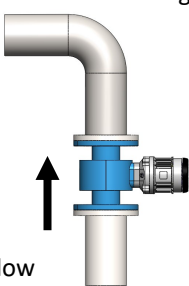

Vertical up flow  
with full pipe

Meter head orientation

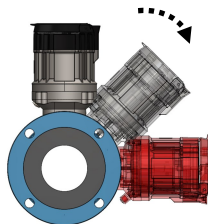

Meter head can  
be clocked only  
up to 45°

Straight Pipe



Elbow



Pump Discharge\*



Check Valve

Note: For questions regarding a specific installation configuration,  
please contact the manufacturer for further support

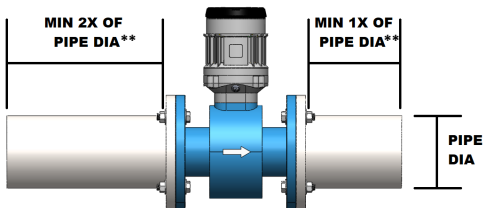

\* When installed near a pump, DO NOT install on the pump suction side  
\*\* Minimum requirement. Longer straight pipe recommended for optimal readings



Elbow

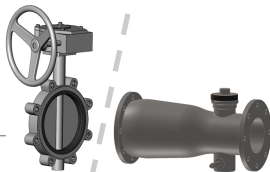

Valve

Installations and Grounding

Standard Metal Pipe Installation

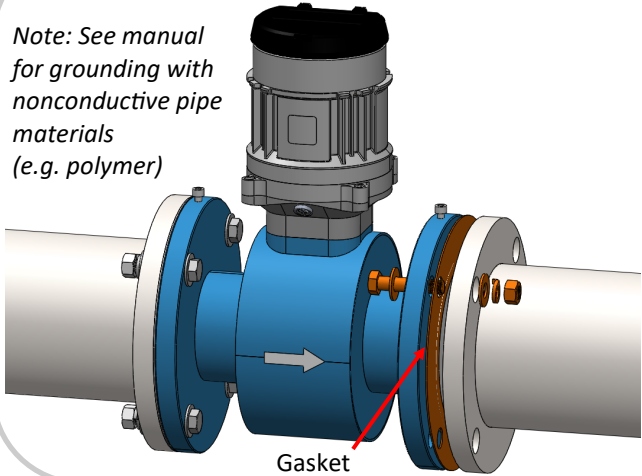

Grounding

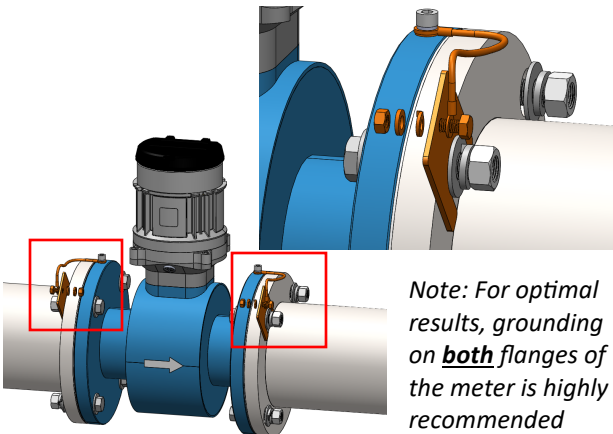

Wiring

General Wiring Schematic\*

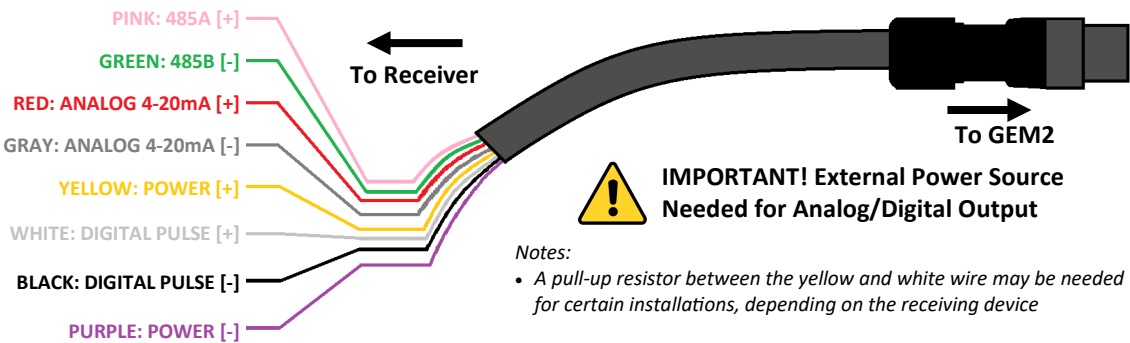

\*Refer to IOM manual for wiring details on Sensus data cable

K Factor Settings\*

METER SIZE	2"	3"	4"	6"	8"	10"	12"
PULSES/GALLON	48	20	12	6	3	2	1.5

\*K factors for additional meter sizes can be found in the full IOM manual

Additional Resources

Please refer to our product website <http://www.glotech-corp.com/products/gem/> to find additional information, download the full IOM manual, and to register/activate your product warranty.

Product Warranty

Full IOM Manual

Android App\*

iOS App



\*Use password "GEM" to download the Android app

\*\*Phone applications require password "2988" for operation

For general inquiries, contact the support team at: 954.908.9955 | [gemsupport@glotech-corp.com](mailto:gemsupport@glotech-corp.com)